

Mersey Bluff Cemetery - Memorial

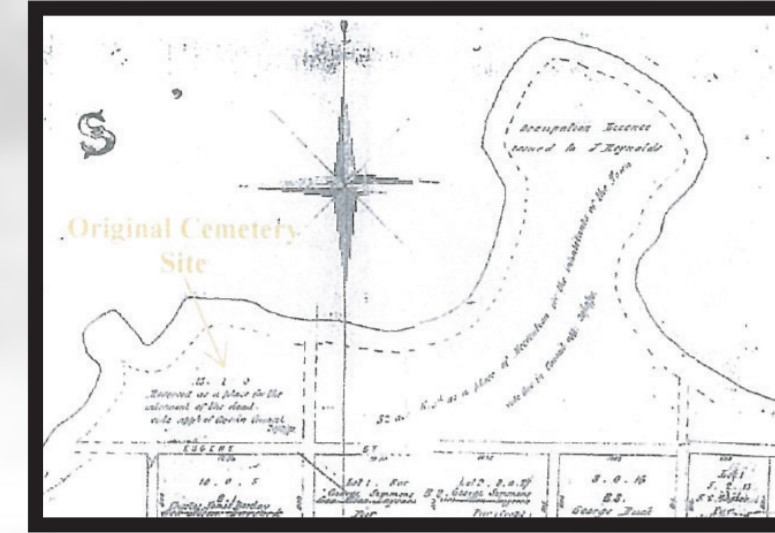

History of the Mersey Bluff Cemetery

Mersey Bluff Cemetery is the resting place of many Devonport pioneers and families from many walks of life. They include carpenters, shipwrights, merchants, policemen, shopkeepers, publicans, bridge builders and ministers, as well as their wives and children.

The original cemetery is said to be located further west of this site, between Back Beach and Coles Beach. The cemetery, and its surviving fabric, is an integral part of the history and heritage of Devonport.

Though not the original site of the Mersey Bluff Cemetery, this location is home to the remaining headstones of those buried at the original cemetery and thus serves as an important connection to the past.

Mersey Bluff Cemetery is one of the oldest surviving burial grounds in Devonport, a place specifically reserved for the burial of the dead from 1878 until the last burial occurred in 1952.

Further information on the Mersey Bluff Cemetery can be obtained through Devonport City Council.

Names of those interred at the original Mersey Bluff Cemetery from 1878-1952

ABBOTT, Charles Campbell
 ALEXANDER, Annie
 ALEXANDER, George Axelby
 ALLEN, William John
 ANDREWS, Alice Lavinia M.
 BAILEY, Annie Christina
 BAILEY, Frances Trixie
 BAILEY, Frances Xavier
 BAKER, Ethel Mary Ann Helen
 BARBER, Thomas
 BASTONE, Henry
 BELL, George Renison
 BELL, Phoebe
 BERRY, Agnes
 BLYTH, Frances Mary
 BRADFORD, Harriet
 BREW, Ada May
 BROWN, Charles
 BROWN, Mary Ann
 BRUMBY, Elizabeth
 BRUMBY, Margaret
 BULLOCK, Flora
 BURKE, Michael
 BURR, Ellen
 BURR, Martha
 BURR, Mary Ann
 BURR, Wesley
 BURT, Margaret Maria
 BUTLER, William
 BUXTON, Eva Florence
 BYRON, Garratt
 CARDEN, John Minchin
 CARROLL, Joseph William
 CARROLL, Mary
 CARROLL, William Joseph
 CHELLIS, Fanny
 CHRISTENSEN, Andrew
 CHRISTENSEN, Lorenze James
 CLAYTON, Charles W.
 CLAYTON, Laura Margaret
 CLAYTON, Mary Elizabeth
 CLAYTON, Mrs H.C.
 CLEMENTS, Walter Frederick
 COCKER, Clara
 COCKER, David
 COLE, Agnes
 COLE, John
 COLE, Murray
 COLE, Nancy
 COLLEDGE, Beatrice Amelia Wakeman

COLLEDGE, Esther
 COLLEDGE, Ethel Blanche Wakeman
 COLLINS, Leslie Kenneth
 COLLYER, Bessie
 CONVERY, Joseph A.
 COOK, William
 CORBELL, Ellen
 CORNELIUS, Joseph Elliott Verdun
 CURNER, Frederick George
 CURWEN, Claire May
 CURWEN, Robert Newton
 DAVIS, John
 DAVIS, John Jnr.
 De NAVERNE, Charles Victor Corso
 De NAVERNE, Mary Gibb
 DEAN, Catherine
 DELPHIN, Elsie
 DENBY, Bridget
 DENBY, Henry
 DOLTING, Emma Elizabeth Susan
 DOLTING, John
 DONOHUE, Ada
 DONOHUE, Eveline Beatrice
 DONOHUE, Nora
 DOWNING, Edward
 DRISCOLL, Jean
 DRISCOLL, Richard
 DRISCOLL, Richard John
 EASTON, Agnes Kerr
 EASTON, Edward
 EDMUNDS, Albert
 EDWARDS, James
 EDWARDS, William John
 FERRALL, Andrew
 FERRALL, Stuart Edgar
 FISHER, Kate Winifred
 FITCH, Louisa
 FLOWERS, Linda May
 FLOYD, Victoria May
 FRASER, Edward Walter
 GIBSON, Malcolm Arthur
 GIBSON, Mavis Eileen
 GOWANS, David
 GOWANS, Mary Ann
 GRAHAM, Amy Frances
 GRAHAM, Angus
 GRAHAM, Neil
 GRAHAM, Margaret
 GRAVES, Joseph Brain
 GREEN, Mary

GREENHILL, Frank Harry
 GREENHILL, Janet Masterton
 GRIEVE, Christina Mary
 GRIEVE, Isabella Sutherland
 GRIFFITHS, Mary Jane (Laura)
 GUNYON, George
 HALLEY, Ethel
 HANSEN, Arthur Ernest
 HANSEN, Frederick George
 HANSEN, Peter
 HARRIS, Elizabeth G.
 HAWKINS, George Joseph
 HAWKINS, Ronald Newman
 HAWKINS, William Thomas
 HENDERSON, Alice Mary
 HENDERSON, Mary T.
 HENIGAN, Florence Ada
 HENIGAN, Harold William
 HENIGAN, Owen
 HENIGAN, Percy John
 HENIGAN, William Thomas
 HERBERT, Maryann
 HEY, Henry Edward
 HEY, Lyell Vincent
 HILL, Ethel Susannah
 HILL, Jane
 HILL, Walter Vincent George
 HILLER, Caleb Joshua
 HILLER, Matilda Ann
 HOWARD, Anthony
 HYNES, Caroline
 IMLACH, Louisa Mary
 IMLACH, Thomas
 INNES, Adeline
 INNES, Carlton
 INNES, John Montague
 INNES, Maude Allsopp
 INNES, Nina
 INNES, William
 ISAACS, Florence Hilda
 JACQUES, Jane
 JACQUES, John
 JOHNSTON, Eliza Amelia
 JOHNSTON, Sophia
 JOHNSTONE, Alice Susanna
 JONES, Lloyd Campbell
 KEMPLING, James Bernard
 KEMPLING, James Gordon
 KENNY, Thomas
 KENNY, Thomas Snr.

KENZIE, George Edward
 KERSLAKE, Idilia Jessie
 KILPATRICK, Lawrence C.
 KINGSHOT, Willis Jean
 LAMPREY, Samuel
 LAURENCE, Joseph Clarke
 LAWLER, George Frederick
 LAWLER, Susan
 LAWSON, Betty
 LAWSON, Mary Lyle
 LAYCOCK, Beaumont
 LAYCOCK, Beaumont
 LAYCOCK, Horace Carl
 LAYCOCK, Julia
 LAYCOCK, Samuel Claude
 LAYCOCK, Sarah Vedas
 LAYCOCK, Stanley
 LEEK, Foster
 LEEK, Harriet
 LEWIS, Garnet William Henry
 LLOYD, Thomas
 LOCKWOOD, James Frederick
 LOCKWOOD, John
 LOCKWOOD, John L.
 LOCKWOOD, William George
 LODGE, Thomas
 LOVETT, Charlotte
 LOVETT, William Eric
 LOVETT, William John
 LUCK, Hilton John
 LUCK, Isabella Beatrice
 LUCK, John
 LUCK, Kate Alice
 LUMSDEN, Robert
 MARSHALL, Mary Emma
 MARSHALL, Thomas Wilson
 MASTERMAN, Pauline Marie
 MASTERMAN, Robert
 McCULLOCH, Anthony J.
 McCULLOCH, Elizabeth
 McCULLOCH, George
 McCULLOCH, William L.
 McCUSKER, James
 McDONELL, Sylvia Joy Virginia
 MEADE, Honorah
 MENNIE, James
 MILES, Donald Charles
 MILLER, Thomas Stewart
 MILLER, Tomasina Anderson
 MILLER, William Stuart

MILLHOUSE, Mavis Lorraine
 MITCHELL, Doris Pretoria
 MITCHELL, Ruth Stella
 MOORE, Frances Evelyn
 MOORE, Harriet Eva
 MOORE, Lorenzo
 MOORE, Rubena Ellen
 MOORE, Wilfrid A.
 MORGAN, Dorothy Annie
 MORGAN, Harry Clarke
 MORGAN, Sarah Jane
 MUCKRIDGE, George Frederick
 MUIR, Frederick
 NAYLOR, James
 NAYLOR, Joseph
 NAYLOR, Ruth
 NAYLOR, Sarah
 NEAL, Fanny Ann
 NEAL, James Henry
 NEAVE, John Hamilton
 NEIL, Roydon
 NICHOLS, James
 NIELSEN, Hans
 NIELSEN, Kenneth Kingsley
 NIELSEN, Oliver Stanley
 NIELSEN, Rupert Leo
 NIELSEN, Selina Elvina May
 O'CONNOR, Willie James
 O'KEEFE, Frank
 PARISH, William Alexander
 PEARCE, Harry
 PENDREY, Baby
 PENDREY, James
 PONSONBY, Malvina Luttrell
 PRICE, Julia
 QUINLAN, Michael
 QUINLAN, Thomas William
 RAND, Edna
 RAND, George
 RAY, Susannah
 RAY, Thomas
 REDGATE, William
 REDPATH, David
 REID, Mary Catherine
 REYNOLDS, John
 RICHARDS, Amy Elizabeth
 RICHARDS, Terence Graham Martin
 RING, Ada Jane
 RING, Ada Mary
 RITCHIE, Alexander Wood

ROBERTS, Anthony
 ROBERTS, Lenora Serena
 ROBINSON, Daisy May
 ROGER, James Campbell
 ROSS, Dorothea Margaret
 ROSS, James
 ROSS, James
 ROSS, Lucy Dorothy
 RUDD, Eliza Alice Amelia
 RUDD, Robert James
 SADLEIR, Ella
 SAWYER, Charlotte Eliza
 MUIR, Frederick
 SAWYER, Joseph
 SAWYER, Mary Ann
 SAWYER, Seth
 SHEEAN, Bridget Annie
 SHEEAN, John Deeming
 SLATER, Alfred
 SMEE, Charles
 SMEE, George Frederick
 SMITH, Anna Frances
 SMITH, George Vincent
 SMITH, Grace
 SMITH, Harry
 SMITH, Lavinia Margaret
 SMITH, Robert Boag
 SMITH, William Patrick
 SMITH, William Peter
 SPLANE, Margaret S.
 SPLANE, Martin William
 SPLANE, Mary Teresa
 STANTON, Florence Edith
 STEPHENS, Edith Florence
 STEPHENS, Isabella
 STEPHENS, James
 STEPHENS, William
 STOKES, Daphne Camelia
 STONE, Ethel Louisa
 SULLIVAN, Annie May
 SWIFT, Florence Maud
 TAYLOR, Charles Wilmot
 TAYLOR, James
 THOM, David Stirling
 THOM, John
 THOMAS, Louisa Caroline
 THOMAS, William Henry Lionel
 THOMPSON, Harriet
 TOLLAND, Angelina Eliza
 TURNELL, Joseph

UPWARD, Jane M.
 WAGNER, Glory Pearl
 WALDRON, Louisa Mary
 WALDRON, Louisa
 WALDON, Percy Allen
 WALDON, William
 WALDRON, Florence Rita
 WALKER, Herbert John
 WALPOLE, Lilian Mary
 WALPOLE, Margaret
 WEBSTER, Ada Florence
 WELLER, Elena
 WELLER, Henry
 WELLER, Mary Ann
 WELLER, Myrtle
 WELLER, Norman
 WHITE, Eric Edwin
 WILES, Hannah Priscilla
 WILLER, Mary Ann
 WILLIAMS, Augustus
 WILLIAMS, Edith Amelia
 WILLIAMS, Emily
 WILLIAMS, George Pyrmont
 WILLIAMS, Henrietta
 WILLIAMS, John
 WILLIAMS, Margaret S.
 WILLIAMS, Thomas James
 WILSON, Ivy Jane
 WILSON, Jane
 WINSOR, William Richard
 WOLFE, Malcolm Charles
 WOLFE, Thomas
 WOOD, Annie
 WOOD, Elizabeth
 WOOD, Ethel May
 WOOD, Grace
 WOOD, Harry
 WOOD, Michael
 WOOD, Susannah
 WOOD, Thomas Harry Holyman
 WOOD, William Holyman
 WOOLLAM, Henry
 WRIGHT, Mary Josephine

All efforts have been made to ensure utmost accuracy. Information sourced from the Tasmanian Family History Society Inc. Devonport Branch.